

# Venturi Injector

## AQ - 115RS

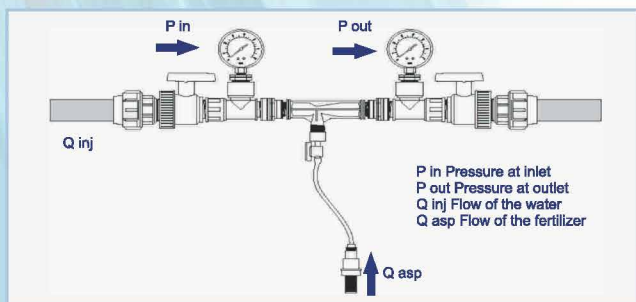

### Typical Installation



\*The test carried out by using water as suction liquid.

### Performance Data

Pressure		2" venturi Injector Low Flow (Model 115LF)		2" venturi Injector High Flow (Model 115HF)	
P. in	P. out	Q inj	Q asp	Q inj	Q asp
Kg/cm2	Kg/cm2	Motive Flow L/H	Water Suction L/H	Motive Flow L/H	Water Suction L/H
0.5	0	3141	800	10320	2000
0.75	0	3924	835	12300	2000
	0	4697	850	14400	2000
1	0.25		700		1900
	0.5		400		1800
1.5	0	5741	900	16800	2000
	0.5		700		1980
	0.75		400		1500
2	1		150		1900
	0	6598	900	18900	2000
	0.5		810		2000
	0.75		710		1800
	1		500		1500
2.5	1.25		271		1020
	1.5		200		600
	0	7346	900	20100	2000
	0.5		900		2000
	0.75		890		1980
	1		800		1580
3	1.25		750		1500
	1.5		400		1080
	1.75		250		720
	2		200		N/S
	0	8041	900	22500	2000
	1		900		2000
	1.25		850		2000
	1.5		750		1620
3.5	1.75		450		1500
	2		250		840
	2.25		200		520
	2.5		150		N/S
	0	8688	900	24300	2000
	1		900		2000
	1.5		850		2000
	1.75		750		1800
4	2		450		1580
	2.25		300		1490
	2.5		250		860
	2.75		200		N/S
	0	9290	900	25800	2000
	1		900		2000
	2		800		1500
	2.25		700		1400
4.5	2.5		400		1020
	2.75		200		840
	3		150		580
	3.25		100		N/S
	0	9841	900	26400	2000
	1		900		2000
	2		880		2000
	2.5		800		1700
5	2.75		500		1500
	3		300		500
	3.25		250		350
	3.5		200		N/S
	3.75		150		N/S
	0	10397	900	28500	2000
	1		900		2000
	2		850		2000
5.5	3		700		1900
	3.25		500		1400
	3.5		310		700
	3.75		250		400
	4		200		N/S
	4.25		150		N/S
	0	10866	900	30000	2000
	1		900		2000
6	2		900		2000
	3		850		1800
	3.25		700		1800
	3.5		550		1000
	3.75		450		900
	4		320		800
	4.25		270		200
	4.5		200		N/S
6	4.75		150		N/S
	0	11171	900	32000	2000
	1		900		2000
	2		900		2000
	3		850		1900
6	4		700		1800
	4.25		600		700
	4.5		510		500
	4.75		400		N/S
	5		250		N/S

# Venturi Injector

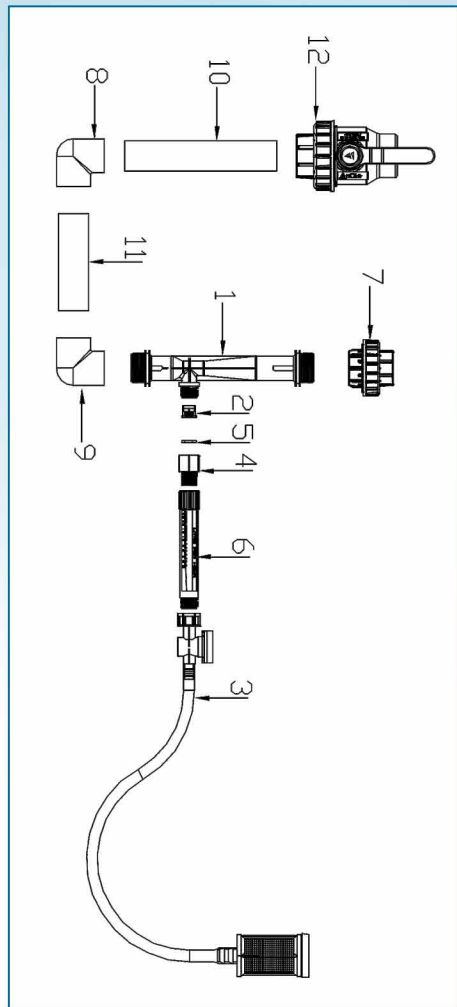

## AQ-115RS

ITEM CODE	MODEL NO	DESCRIPTION	CONNECTION SIZE
20030004	115	2" Venturi With Suction Port (L.F)	2" BSP (63 mm)
20030005	115	2" Venturi With Suction Port (H.F)	2" BSP (63 mm)
20030009	115	2" Venturi With Suction Port (L.F)	2" NPT(63 mm)
20030010	115	2" Venturi With Suction Port(H.F)	2" NPT(63 mm)
20010004	115R	2" Venturi With Suction Port & Rotameter(L.F)	2" BSP (63 mm)
20010005	115R	2" Venturi With Suction Port & Rotameter(H.F)	2" BSP (63 mm)
20010009	115R	2" Venturi With Suction Port & Rotameter(L.F)	2" NPT(63 mm)
20010010	115R	2" Venturi With Suction Port & Rotameter(H.F)	2" NPT(63 mm)
20060004	115S	2" Venturi Assy with Suction Port (L. F.)	2" BSP (63 mm)
20060019	115S	2" Venturi Assy with Suction Port (L. F.)	2" BSP (63 mm)
20060009	115S	2" Venturi Assy with Suction Port (L. F.)	2" NPT(63 mm)
20060010	115S	2" Venturi Assy with Suction Port (L. F.)	2" NPT(63 mm)
20050004	115RS	2" Venturi Assy With Suction Port & Rotameter(L.F)	2" BSP (63 mm)
20050005	115RS	2" Venturi Assy With Suction Port & Rotameter(H.F)	2" BSP (63 mm)
20050009	115RS	2" Venturi Assy With Suction Port & Rotameter(L.F)	2" NPT(63 mm)
20050010	115RS	2" Venturi Assy With Suction Port & Rotameter(H.F)	2" NPT(63 mm)

### SPARE PARTS

S. NO	PARTS NAME	PART CODE	MATERIAL	QTY
1	VI Body LF (BSP) Black	12450003	Glass reinforced PP	1
	VI Body LF(NPT) Black	12450004		
	VI Body HF (BSP) Black	12450001		
	VI Body HF(NPT) Black	12450002		
2	NRV	20000005	Glass reinforced PP	1
3	Suction Port Assy	20000004	Glass reinforced PP	1
4	Adaptor	12450016	PP	1
5	Adaptor Washer	50020010	NBR	1
6	Rotameter Assy	20000008	Glass reinforced PP	1
7	Union 63MM (TXT)	19070531	PVC	1
8	Elbow (PXP)63MM	12240030	PVC	1
9	Elbow 63MM(PXT)	12240029	PVC	1
10	Pipe 63MM (LENGTH-580 mm)	50100002	PVC	1
11	Pipe 63MM (LENGTH-310 mm)	50100002	PVC	1
12	2" Long Blue Handle Ball Valve (PXT) S.U	19070528	PVC	1