

Venturi Injector

AQ-114RS

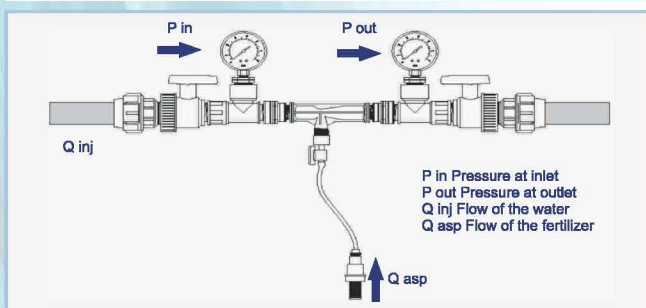

Typical Installation



*The test carried out by using water as suction liquid.

Performance Data

Pressure		1-1/2" Venturi Injector (Model 114)	
P. in	P. out	Q inj	Q asp
Inlet Pressure kg/cm ²	Outlet Pressure kg/cm ²	Motive Flow L/H	Water Suction L/H
0.5	0	3238	698
0.75	0	3902	798
1	0	4532	808
	0.25		780
	0.5		506
1.5	0	5712	811
	0.5		802
	0.75		631
	1		317
	0	6590	814
2	0.5		808
	0.75		808
	1		719
	1.25		518
	1.5		215
	0	7428	814
	0.5		808
2.5	0.75		808
	1		806
	1.25		768
	1.5		594
	1.75		371
	2		112
	0	8163	812
3	1		807
	1.25		807
	1.5		795
	1.75		712
	2		502
	2.25		284
	0	8814	822
3.5	1		820
	1.5		811
	1.75		808
	2		761
	2.25		575
	2.5		356
	2.75		186
0	9422	821	
4	1		808
	2		804
	2.25		793
	2.5		678
	2.75		492
	3		268
	3.25		112
0	9918	826	
4.5	1		814
	2		811
	2.5		794
	2.75		725
	3		558
	3.25		406
	3.5		216
3.75		66	
0	10471	827	
5	1		814
	2		814
	3		796
	3.25		686
	3.5		505
3.75		358	
4		168	

Venturi Injector

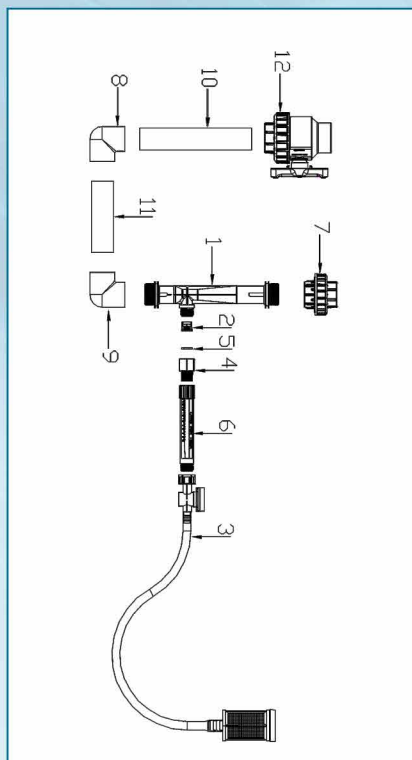

AQ-114RS

ITEM CODE	MODEL NO	DESCRIPTION	CONNECTION SIZE
20030003	114	1.5" Venturi With Suction Port	1.5" BSP (50 mm)
20030008	114	1.5" Venturi With Suction Port	1.5" NPT(50 mm)
20010003	114R	1.5" Venturi With Suction Port & Rotameter	1.5" BSP (50 mm)
20010008	114R	1.5" Venturi With Suction Port & Rotameter	1.5" NPT(50 mm)
20060003	114S	1.5" Venturi Assy With Suction Port	1.5" BSP (50 mm)
20060008	114S	1.5" Venturi Assy With Suction Port	1.5" NPT(50 mm)
20050003	114RS	1.5" Venturi Assy With Suction Port & Rotameter	1.5" BSP (50 mm)
20050008	114RS	1.5" Venturi Assy With Suction Port & Rotameter	1.5" NPT(50 mm)

SPARE PARTS

S. NO	PARTS NAME	PART CODE	MATERIAL	QTY
1	Body (BSP Thread) Black	12430002	Glass reinforced PP	1
	Body (NPT Thread) Black	12430003		
2	NRV	20000014	Glass reinforced PP	1
3	Suction Port Assy	20000003	Glass reinforced PP	1
4	Adaptor	12430008	PP	1
5	Adaptor Washer	50020011	NBR	1
6	Rotameter Assy	20000012	Glass reinforced PP	1
7	Union 50 MM(TXT)	12000002	PVC	1
8	Elbow 50MM (PXP)	12230048	PVC	1
9	Elbow 50MM (TXP)	12430007	PVC	1
10	Pipe 50MM (LENGTH -600 mm)	50100007	PVC	1
11	Pipe 50MM (275 mm)	50100007	PVC	1
12	50 mm SU Ball Valve (PXT)	19070508	PVC	1